

# F145 Pressure refueling nozzle



## 01 F145 Pressure refueling nozzle

The F145 single point nozzle is smaller and lighter in weight, yet maintains the strength, durability and robust design characteristics of the F116/F117 and HU3000/HU4000 series nozzles. The F145 provides a positive leak-tight connection to the aircraft adapter during fuelling operations. It has been designed to use all of the same accessories that are currently available on the F116/F117 series nozzles and is therefore able to be configured to meet any application.

### Additional features

- Floating nose seal design, tolerant to temperature, worn adapters and abuse.
- Dual 3/8" NPT ports available for sampling and vacuum breaker.
- Positive interlock mechanism, internal to the nozzle body. Nozzle cannot be opened unless connected to an aircraft adapter and cannot be removed unless operating lever is in the closed position.
- Operating lever fully protected by a sacrificial wear block. Replaceable by removing a single bolt. Operating lever knob made from a sacrificial material and easily replaced.
- Optional sacrificial wear block, available for additional protection.
- Hose end control valves available in 35 psi, 45 psi, 50 psi and 55 psi.
- Easy to operate swivel dry disconnect available for strainer check.
- Net weight of basic nozzle - 6.2 Pounds (2.81 KGS).

## 02 Key Features

- Designed and independently tested to SAE specification AS5877
- Available with 3 or 6 slot connector, which mates to the standard 3-lug international aircraft adapter
- Accepts all the same accessories as both the F116 and F117 nozzles
- Nose seal is interchangeable with the F117 and F116 nozzles
- Handles are interchangeable with the F117 nozzle
- Easily rotating swivel built into the nozzle body, separate from the quick disconnect
- No scheduled lubrication of the swivel. Swivel is lubricated by the product passing through the nozzle
- Poppet does not require adjustment
- Maximum operating pressure - (150 psig), (10.3 bar)
- Operating temperature range - (- 40 to 165 F), (- 40 to 74C)

## 03 Contact

### Meggitt Shanghai Office

Address: Rm1107, Block A, No.319 XianXia Road, Changning District Shanghai, China

Telephone: +86 21 6278 1096

Website: <https://www.meggitt.com/products-services/ground-fuelling>

### Meggitt (Xiamen) Sensors & Control Co., Ltd.

Address: No. 230 South 5 Gaoqi Road, Xiamen 361006, P.R. China

Telephone: +86 592 5733 666

Website: [www.meggittxiamen.com/gfp](http://www.meggittxiamen.com/gfp)

## F145 Pressure refueling nozzle

### 04 F145 MODS

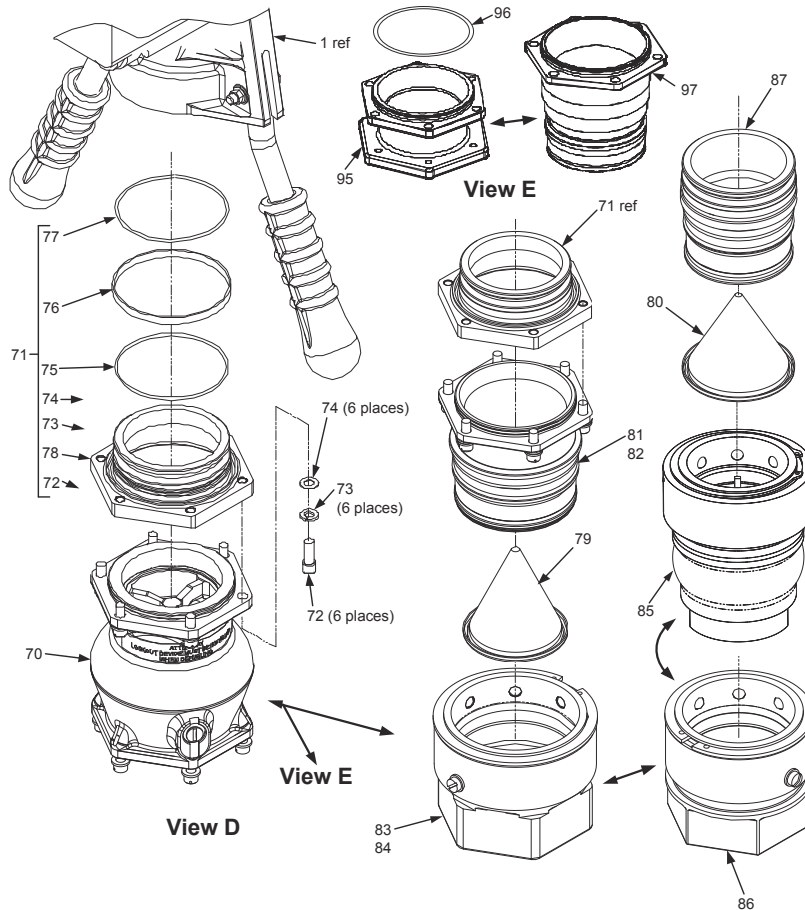

### 05 Model Variations

#### Model Variations

The F145 series nozzle is a straight-in fuelling nozzle with a swivel inlet. It is equipped with bicycle-type grip handles and a dust cover. A flanged swivel adapter is not supplied with the basic nozzle, but can be ordered as a variation. Refer to Tables 2, 3, and 4 for the available F145 series nozzle variations. An explanation of the F145 series part numbering system is as follows:

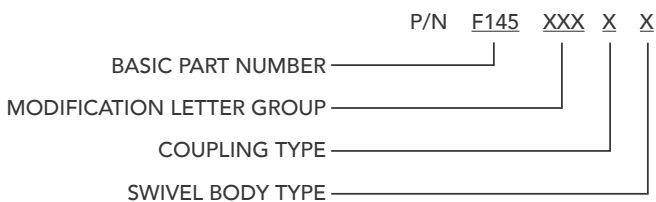

#### P/N Examples:

**F145APV7A** – This three (3) slot nozzle is equipped with a ground cable and has a flanged swivel adapter and a 100 mesh strainer. The coupling is 2.5 inch aluminum with wire raceways to mate with the F582 swivel body. The swivel body has a 2.5 inch NPT inlet.

**F145BPJV7B** – This six (6) slot nozzle is equipped with a vacuum breaker and has a flanged swivel adapter and a 100 mesh strainer. The coupling is 2.5 inch aluminum with wire raceways to mate with the F582 swivel body. The swivel body has a 2.5 inch BSPPL inlet.

Ground Fueling Products

## F145 Pressure refueling nozzle

### 05 Model Variations

Table 1 Nozzle Variations (Mod Code Group after F145)

Examples: F145APV7A, F145BG7A

NOZZLE MOD LETTER	DESCRIPTION	NOZZLE MOD LETTER	DESCRIPTION
A	Adds Ground Cable	M	Adds 0-100PSI Pressure Gauge
B	Adds Vacuum Breaker	N1	Adds 55PSI HECV (Flanged)
C	Changes to Stirrup Handles	N2	Adds 55PSI HECV (Integral Swivel)
D	Change nose seal to F117 (1 Piece)	P	Adds Flanged Swivel Adapter
E	Ring Handles	Q	
F	Adds Drag Ring	R	
G1	Adds 45PSI HECV (Flanged)	S	Interlock Storage Bracket
G2	Adds 45PSI HECV (Integral Swivel)	T	Adds 40 Mesh Strainer
H1	Adds 35PSI HECV (Flanged)	U	Adds 60 Mesh Strainer
H2	Adds 35PSI HECV (Integral Swivel)	V	Adds 100 Mesh Strainer
J	Six (6) Slot Configuration	W	
K	Changes to 10" Long Handles	X	
L1	Adds 50PSI HECV (Flanged)	Y	
L2	Adds 50PSI HECV (Integral Swivel)	Z	

Table 2 Coupling Variations (Type Number between the Mod and Type Letter Groups)

Examples: F145APV7A (Basic model w/ grounding cable, swivel adapter flange, 100 mesh 3" strainer, F582E coupling assembly with 2-1/2 NPT inlet

COUPLING TYPE NUMBER	DESCRIPTION
3	Standard 3-inch aluminum coupling with corrosion resistant steel wire races to mate with F575/F584 swivel body ( uses 3-inch strainer ) *When ordering less HECV must include "P" modification
4	Standard 3-inch aluminum coupling with corrosion resistant steel wire races to mate with F596 dry disconnect swivel assembly ( uses 3-inch strainer ) *When ordering less HECV must include "P" modification
6	Standard 2 ½ inch aluminum coupling with corrosion resistant steel wire races to mate with F1516 dry disconnect swivel body ( uses 2 ½ inch strainer ) *When ordering less HECV must include "P" modification
7	Standard 2 ½ inch aluminum coupling with corrosion resistant steel wire races to mate with F577/F582 swivel body ( uses 2 ½ inch strainer ) *When ordering less HECV must include "P" modification
8	Adds F1516 dry disconnect with integral coupling *Option can only be ordered less HECV mod
9	Adds 2 ½ integral coupling, straight *Option can only be ordered less HECV mod

Ground Fueling Products

## F145 Pressure refueling nozzle

### 05 Model Variations

Table 3 Swivel Body Inlet Variations (End Type Letter)

Examples: F145APV7A

SWIVEL BODY TYPE LETTER	DESCRIPTION
A	2 ½ - inch ANPT inlet. Available for couplings types 3, 4, 6 or 7 only
B	2 ½ - inch BSPPL inlet. Available for couplings types 3, 4, 6 or 7 only
C	3-inch ANPT inlet. Available for couplings types 3, 4, 6 or 7 only
D	2-inch ANPT inlet. Available for couplings types 3, 4, 6 or 7 only
E	3-inch BSPPL inlet. Available for couplings types 3, 4, 6 or 7 only
F	2-inch BSPPL inlet. Available for coupling type 6 only
G	3-inch BSPPL inlet. Available for coupling type 7 only
K	4-inch ANPT inlet. Available for coupling type 7 only
T	2-inch female Camlock inlet. Available for coupling type 7 only
U	4-inch female Camlock inlet. Available for coupling type 7 only
V	3 ½ -inch ANPT inlet. Available for coupling type 7 only
X	2-inch BSPPL inlet. Available for coupling type 7 only

F145 Pressure Drop (psi)

